



PRECISION COLLECTION®

Residential Home Builder Database

The Precision Residential Home Builder Database gives you the information you need to begin estimating productively right away. Thousands of standard industry items—from foundation to roofing components—are included to get you started. Just add your own pricing and you're ready to go.

You can also customize the database to fit your unique needs. Precision makes it easy to add your own items, formulas, assemblies, productivity and conversion factors to the database as you estimate.

The database also includes Smart Assemblies™ that let you take off even the most complicated building components like foundations, walls and roofs in just one step. In addition, Precision's Quick Takeoff Smart Assemblies help you provide customers with "conceptual" estimates within minutes. By answering simple questions such as land cost, living area and building difficulty, you can create fast, accurate "conceptual" estimates that are based on historical costs.

General Database Specifications

- More than 4000 items
- More than 700 formulas
- 68 Smart Assemblies
- 47 Bill of Materials Classes

Assembly Groups	Number of Assemblies
Quick Takeoff	4
Foundation & Slabs (Typical)	7
Foundation & Slabs	11
Walls	11
Floors	4
Stairs	4
Ceilings	1
Roof Systems	6
Exterior Elevations	2
Thermal & Moisture Protection	1
Finishes - Drywall/Metal Studs	6

The Residential Home Builder database documentation outlines the construction logic used in setting up each of Timberline's Smart Assemblies™...

Home Builder Database

File Edit Bookmark Options Help

Help Topics Print

0602 Interior Wall (combination)

Assumptions Items Variables Drawing

Assumptions

Assembly 0602 assumes you need to generate a detailed lumber list for ordering lumber while generating subcontract plug numbers for drywall, paint and base trim. The unit price of the subcontracted items may be adjusted in the spreadsheet later as bids are submitted. The assembly affords the estimator a high degree of flexibility by combining detailed framing takeoff with subcontract unit price items.

- If your framing subcontractor provides lumber as part of his subcontract, then you may generate a framing estimate based on a square foot unit cost similar to the method used in the Quick Takeoff Assemblies.

Items

Phase	Item	Description	Unit
		Treated Plate	
		Plate	
		Studs	
		Blocking	
		Let-In-Bracing	
60912	b001	2x4 RL Temporary Bracing Mate	lf
		Formula: Brace Plumb/Line LF	
92500	400	Drywall Wall 1/2" X	sf
		Formula: Area Wall x 2	
94020	220	Colonial Base FJ 3-1/2"	lf
		Formula: Length LF *2	
99000	10	Painting	sf
		Formula: Area Wall x 2	

...and includes a drawing that lets you see its associated variables.

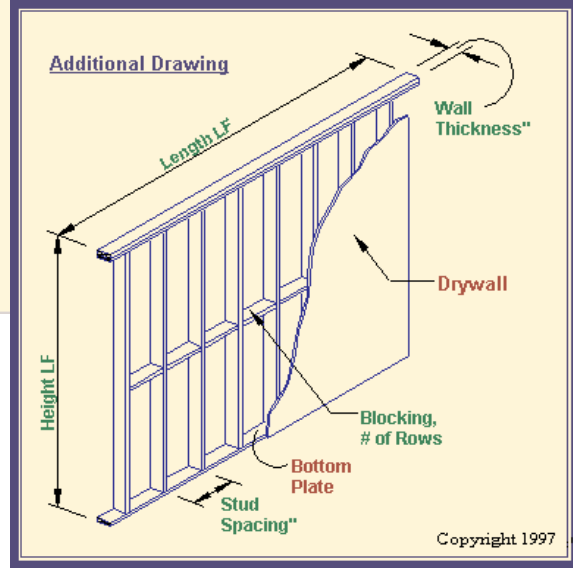

Your Timberline Solution Provider:

Software that fits your business™



Timberline Software Corporation
800.628.6583 • Fax 503.439.5010 • www.timberline.com

TIMBERLINE and the Timberline logo as it appears in this document are registered Marks, "Software that fits your business" and Smart Assemblies are trademarks, and Precision Collection is a registered trademark of Timberline Software Corporation. All other trademarks or registered trademarks are the property of their respective holders.
2/00